

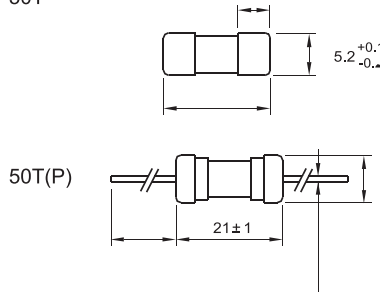

Φ5.2x20mm IEC STANDARD FUSE COMPLIANT & Pb-Free
 LOW-BREAKING CAPACITY CLASS
 TUBE FUSE (TIME-LAG)

BREAKING CAPACITY/
 35A OR 10In 250V AC WHICHEVER IS GREATER

Dimensions/
 50T



Standards/ IEC 60127 GB 9364
Operating Temperature/ -55 -125
Storing Temperature/ -55 -85
Resistance to soldering heat/ 260 10s Max
Solderability/ 245 ± 5, 5s ± 0.5s

50T AVERAGE I-T CHARACTERISTICS CURVE
 (FOR REFERENCE ONLY)

50T I-T ()

TIME(S)/ 时间 (秒)

TECHNICAL PARAMETERS/

PART NO. 目录编号	CURRENT RATING 额定电流	MAX. VOLTAGE DROP 最大电压降 (mV)	SAFETY APPROVALS 安全认证										REFERENCE (A ² .Sec.) (RoHS) I-T 参考值		
			CCC	CQC	SEMKO	VDE	BSI	IMQ	UR (CUR)	CSA	PSE	KC			
50T-0100H	100mA	2500	●												0.0223
50T-0125H	125mA	2000	●												0.0417
50T-0160H	160mA	1900	●												0.0767
50T-0200H	200mA	1500	●												0.1628
50T-0250H	250mA	1300	●												0.3808
50T-0315H	315mA	1100	●												0.4833
50T-0400H	400mA	1000	●												0.7968
50T-0500H	500mA	900	●												1.362
50T-0630H	630mA	300	●												1.583
50T-0800H	800mA	250	●												3.004
50T-010H	1A	150	●												5.309
50T-013H	1.25A	150	●												3.879
50T-016H	1.6A	150	●												6.890
50T-020H	2A	150	●												12.33
50T-025H	2.5A	120	●												20.63
50T-032H	3.15A	100	●												36.91
50T-040H	4A	100	●												70.56
50T-050H	5A	100	●												108.7
50T-063H	6.3A	100	●												187.8
50T-080H	8A	100	●												314.9
50T-100H	10A	100	●												583.4
50T-120H	12A	80	●												958.9
50T-125H	12.5A	80	●												1045
50T-150H	15A	80	●												1668
50T-160H	16A	80	●												2231
50T-200H	20A	80	●												3010

DENOTES FOR APPROVED

H DENOTES FOR 250V H 250V

REMARK

50T (P)-160H WITHOUT VDE AND SEMKO APPROVAL

50T (P)-160H VDE SEMKO

ELECTRICAL CHARACTERISTICS/

RATING 额定		BLOWING TIME 熔断时间		
		100mA	125mA-10A	>10A
2.1In	Max. 最慢	2 minutes	2 minutes	5 minutes
	Min. 最快	200 ms	600 ms	600 ms
2.75In	Max. 最慢	10 seconds	10 seconds	15 seconds
	Min. 最快	40 ms	150 ms	150 ms
4In	Max. 最慢	3 seconds	3 seconds	5 seconds
	Min. 最快	10 ms	20 ms	20 ms
10In	Max. 最慢	300 ms	300 ms	400 ms

CURRENT(A)/ 电流 (安培)